

Bonus \$1.50 Co-op Fee
Half Market Rents



For Sublease: Office

610 Chartwell Road

Flexible Plug & Play Opportunity in Oakville

Lennard:

Here is where your business will *grow*.

lennard.com

610 Chartwell Road

Up to 14,645 SF (divisible) of premium turnkey office space for Sublease at the southwest corner of South Service Road and Chartwell Road.



Suite

101

Available Space

Up to 14,645 SF

Option 1: 14,645 SF

Option 2: 10,592 SF
(Divisible to 5,000 SF)



Net Rent

Contact Listing Agents

Additional Rent

\$12.60 PSF



Availability

60 Days

Term

January 31, 2028
(Flexible)



Listing Agents

Jay Goldenberg*

Vice President

416.649.5908

jgoldenberg@lennard.com

Leila Agic*

Associate Vice President

416.649.5944

lagic@lennard.com

*Sales Representative

Property Highlights

- State of the art workspace environment with natural light
- Built out with meeting rooms, private offices, open area with workstations and kitchenette
- On site amenities including café that provides purified air
- Building is LEED Gold Certified
- Parking available
- Fully furnished

610 Chartwell Road

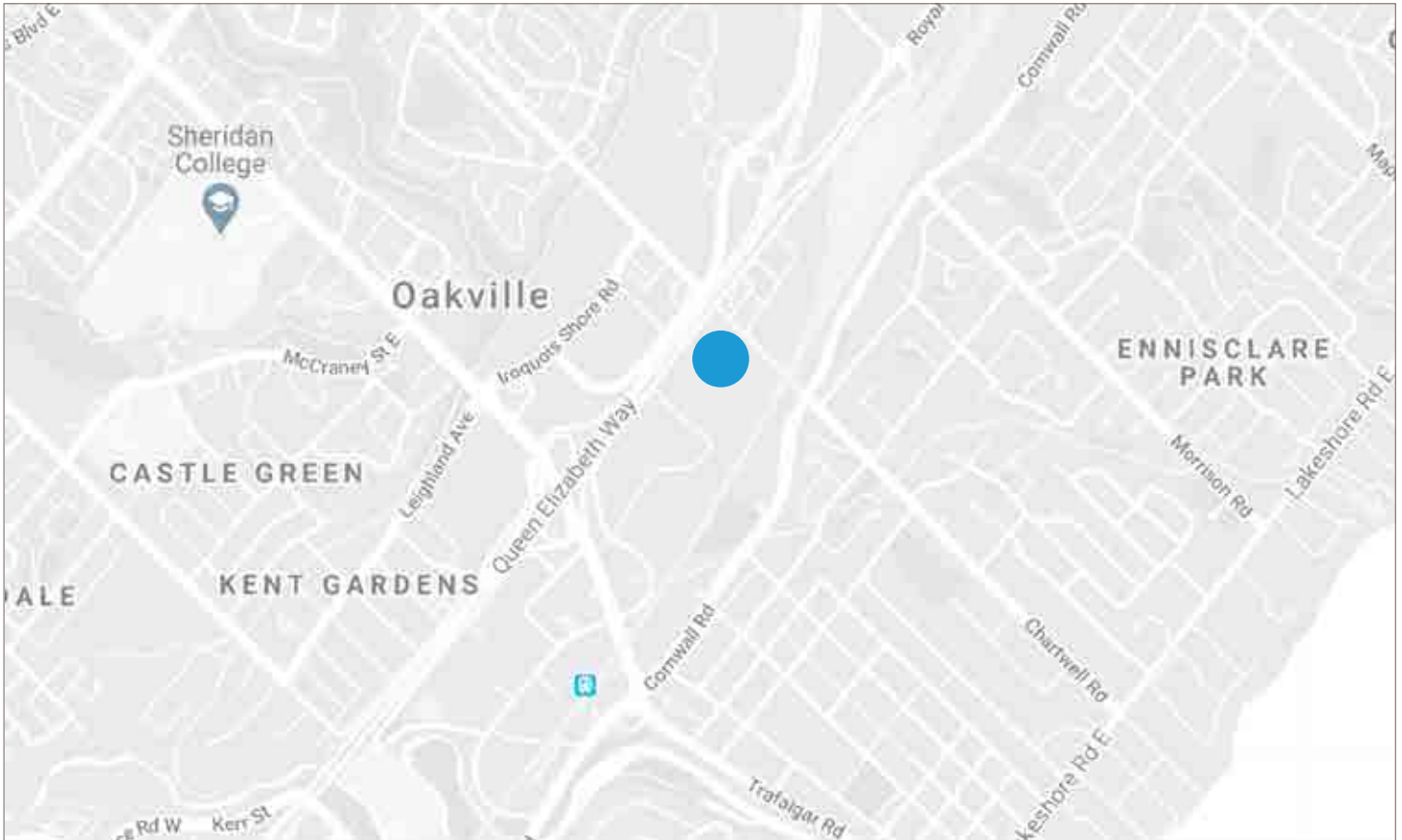

What's Near By

- Just a short walk from the Oakville Trafalgar GO transit station and easy access to highways
- Serviced by a dedicated Oakville Transit bus route providing a direct route from Oakville Trafalgar GO station to the building for easy transport during peak hours
- Direct nearby amenities include: Whole Foods, Beertown, Harper's Landing, Burger's Priest, BMO, RBC, etc.

Statements and information contained are based on the information furnished by principals and sources which we deem reliable but for which we can assume no responsibility. Lennard Commercial Realty, Brokerage 2022.

610 Chartwell Road

Floor Plan: Suite 101

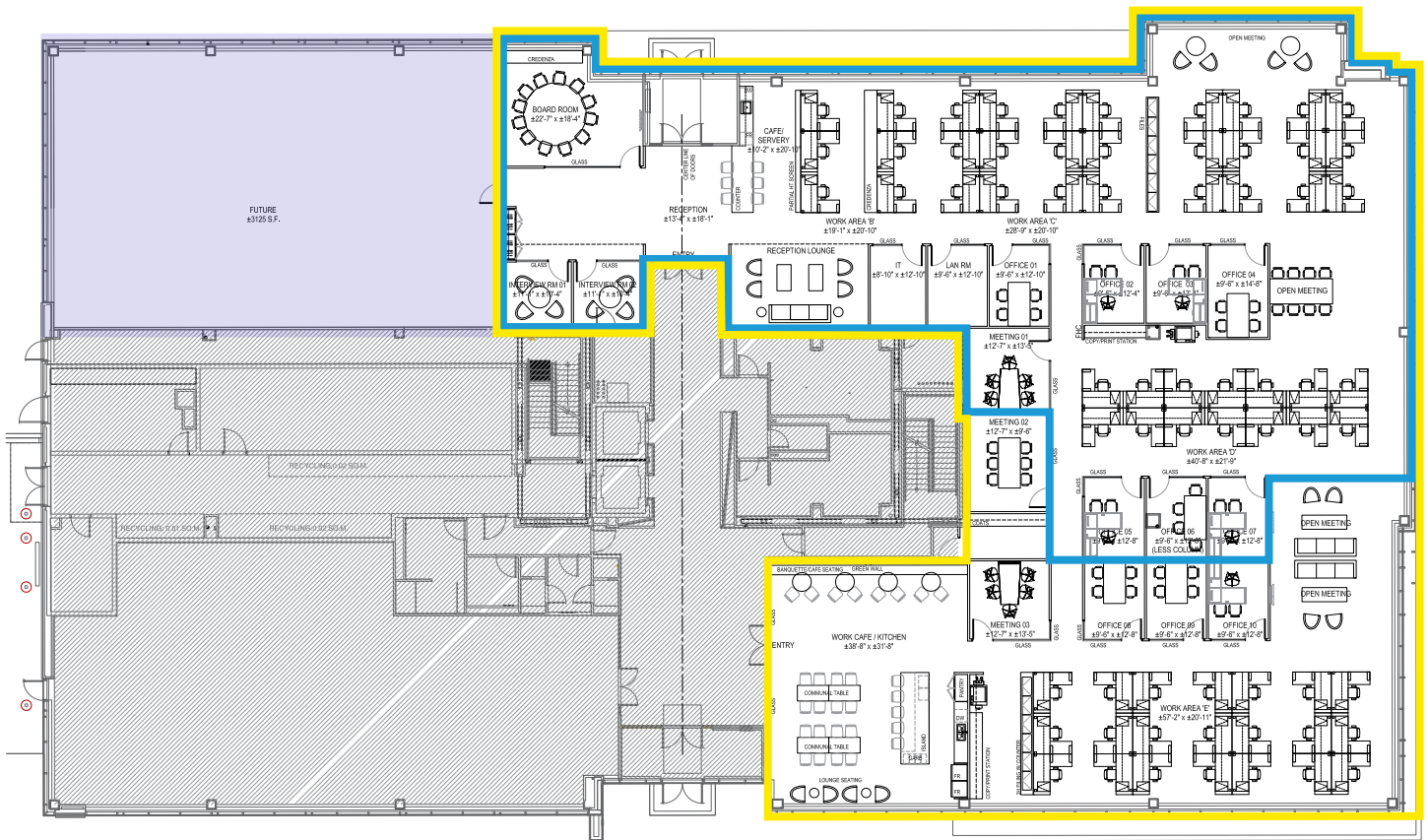

Option 1: 14,645 SF

Option 2: 10,592 SF (Divisible to 5,000 SF)

*Furniture may not be laid out exactly as pictured

610 Chartwell Road



Lennard:

lennard.com

610 Chartwell Road

