



For Lease

# #10-2415 Stevenage Drive

Opportunity to lease a rarely offered industrial unit in an established industrial neighbourhood.

**Lennard:** Imagine the *Possibilities*.



# #10-2415 Stevenage Drive



Available Space  
**1,245 SF**



Net Rent  
**\$17.50 PSF**

Additional Rent  
**\$8.02 PSF (approx.)**



Availability  
**Immediate**



Zoning  
**IH**



Shipping  
**1 Dock Level**



Clear Height  
**18'**



Listing Agent  
**Ian Shackell\***  
Partner

D. 613.963.2633  
C. 613.761.0177  
ishackell@lennard.com

**Matt Shackell\***  
Vice President

D. 613.963.2636  
C. 613.612.8812  
mshackell@lennard.com

**Lavel Tiwana**  
Sales Representative

D. 613.963.2635  
C. 613.416.4666  
ltiwana@lennard.com

\*Sales Representative

## Property Highlights

- Rarely offered industrial unit in highly sought out industrial area.
- Located within the Hunt Club and Walkley submarket, an established industrial neighbourhood within Ottawa's east end.
- The property is a multi-tenant industrial and commercial building.
- Close proximity to Highway 417 and other important local arterials.
- The property offers convenient access to a variety of tenant amenities such as Subway, A&W Canada, Boston Pizza, Tim Horton's and McDonald's.

**Lennard:**

# #10-2415 Stevenage Drive

Floor Plan

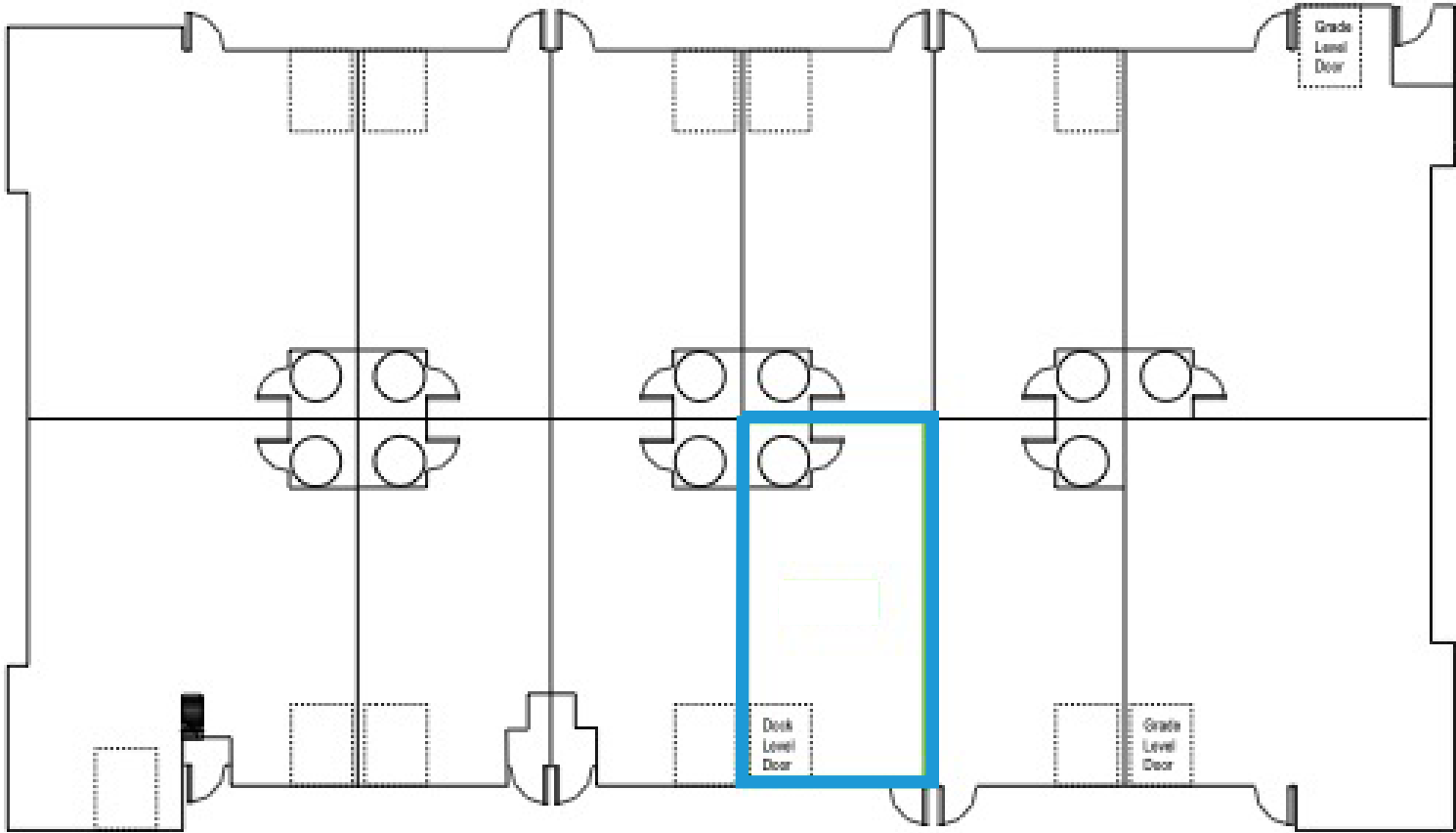

**Lennard:**



# #10-2415 Stevenage Drive



## Photos



**Lennard:**



# #10-2415 Stevenage Drive

## Location Map

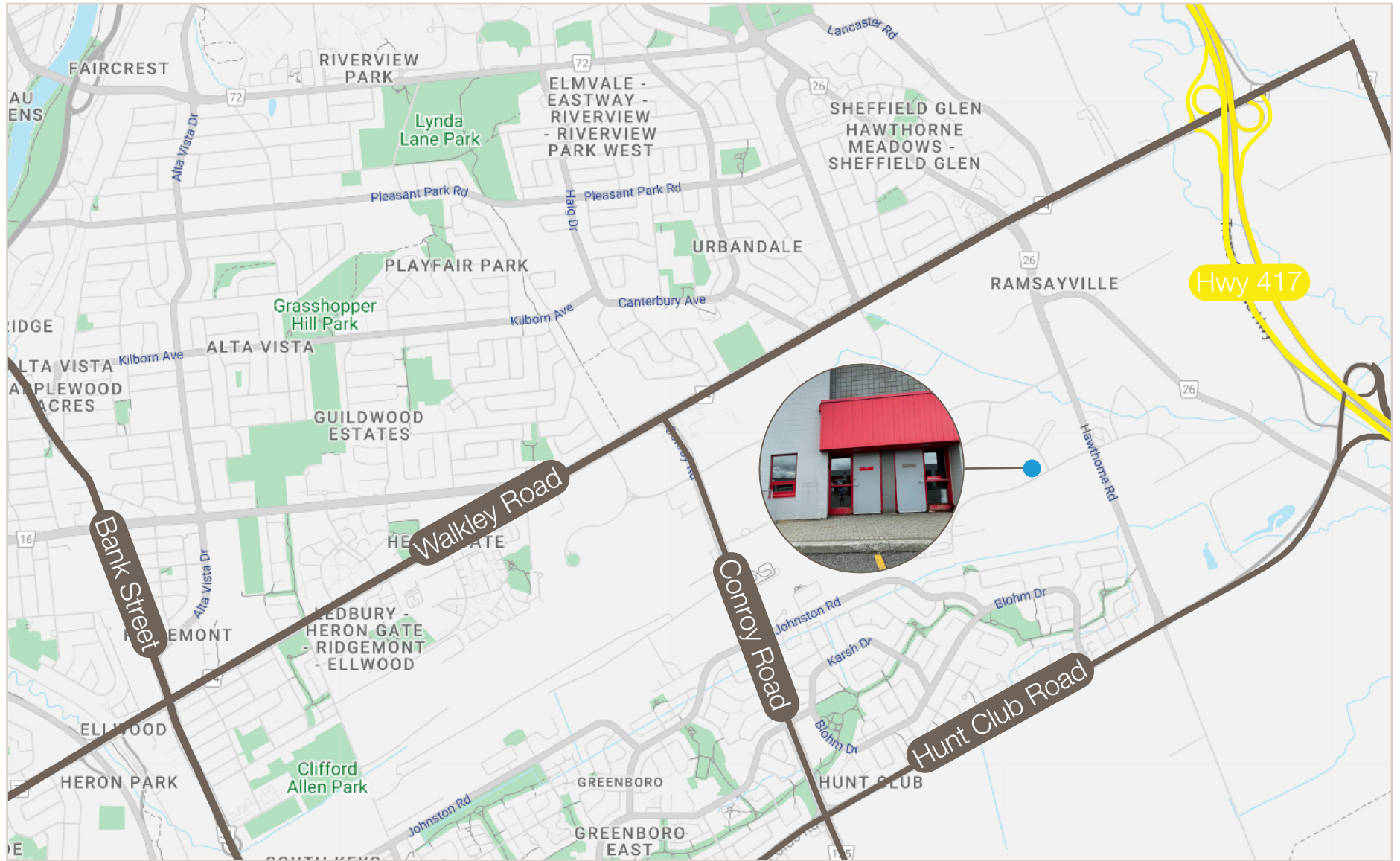

**Lennard:**



## Lennard:

Ian Shackell\*, Partner

D. 613.963.2633

C. 613.761.0177

[ishackell@lennard.com](mailto:ishackell@lennard.com)

Matt Shackell\*, Vice President

D. 613.963.2636

C. 613.612.8812

[mshackell@lennard.com](mailto:mshackell@lennard.com)

Lavel Tiwana, Sales Representative

D. 613.963.2635

C. 613.416.4666

[ltiwana@lennard.com](mailto:ltiwana@lennard.com)

333 Preston Street, Suite 420

Ottawa, ON K1S 5N4

613.963.2640

[lennard.com](http://lennard.com)

\*Sales Representative

Statements and information contained are based on the information furnished by principals and sources which we deem reliable but for which we can assume no responsibility. Lennard Commercial Realty, Brokerage 2023.