



For Sublease: Industrial

1725 McPherson Court

69,411SF Industrial Unit In Pickering

Here is where your
business will *grow*.

Lennard:

209-1 Yorkdale Road, North York
905.752.2220

lennard.com

1725 McPherson Court

69,411 SF of functional industrial unit at the corner of Brock Road and McPherson Court in a sought-after Pickering industrial pocket.



Total Area - Unit 1

69,411 SF

Office

3,471 SF

Industrial

65,940 SF



Shipping Doors

6 Truck Level Doors



Clear Height

24'



Zoning

M2, M2S



Rental Term

114 Months



Power

600 Amps



T.M.I (2023)

\$3.11



Asking Price

\$15.50 PSF



Listing Agent

Jonathan Gorenstein* MBA, SIOR

Partner

905.917.2044

jonathan@lennard.com

Paul Wells**

Associate Vice President

416.275.3514

pwells@lennard.com

*Broker **Sales Representative

Property Highlights

- Well-maintained functional industrial unit
- Brock Road exposure
- Institutionally owned and operated
- Shipping apron depth of 94'
- 3 access points to the property
- Strong labor pool
- Direct access to Highway 401
- Close to Pickering Go Station and Ajax Go Station

Lennard:

lennard.com

1725 McPherson Court



Floor Plan

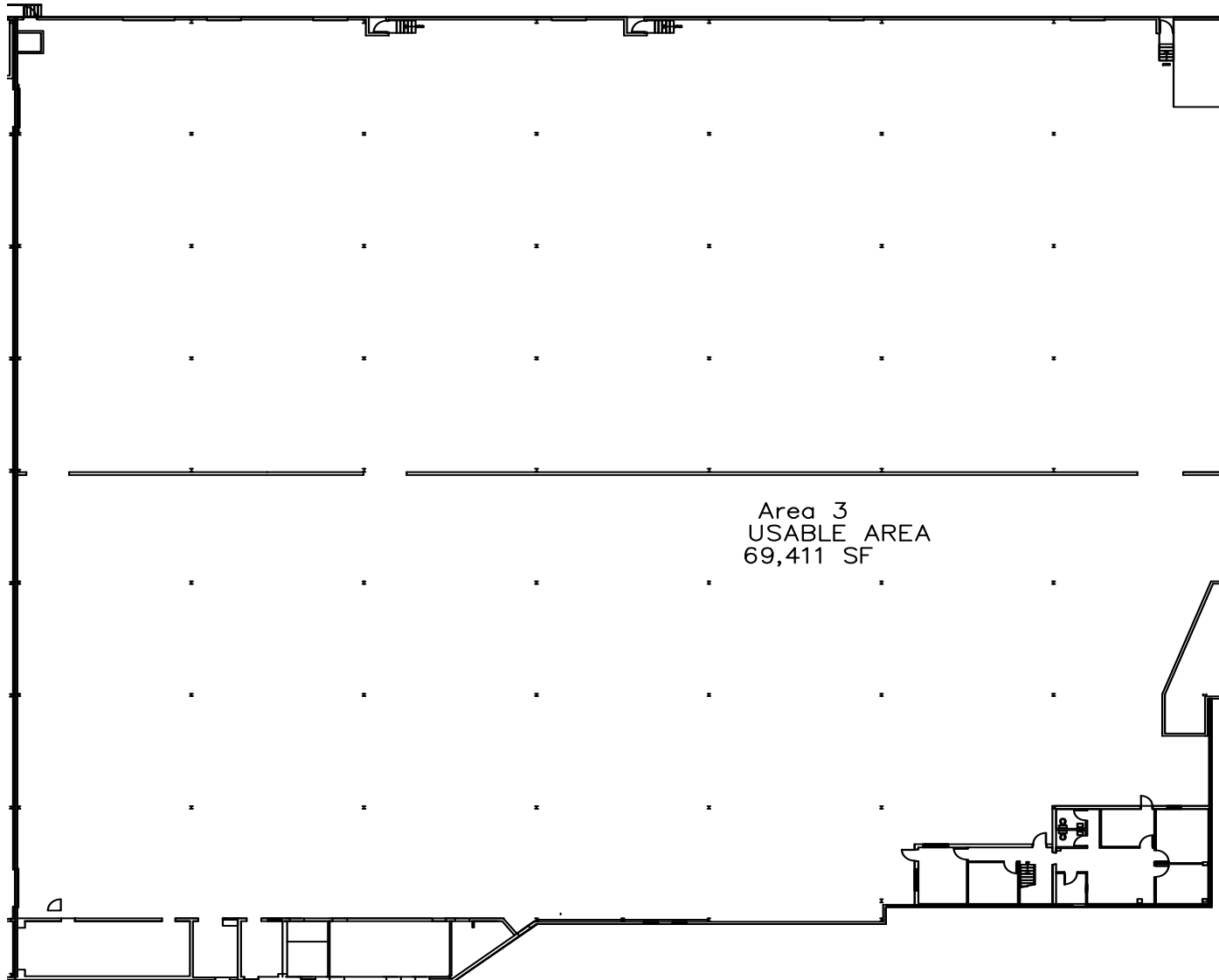

1725 McPherson Court

Map of Location

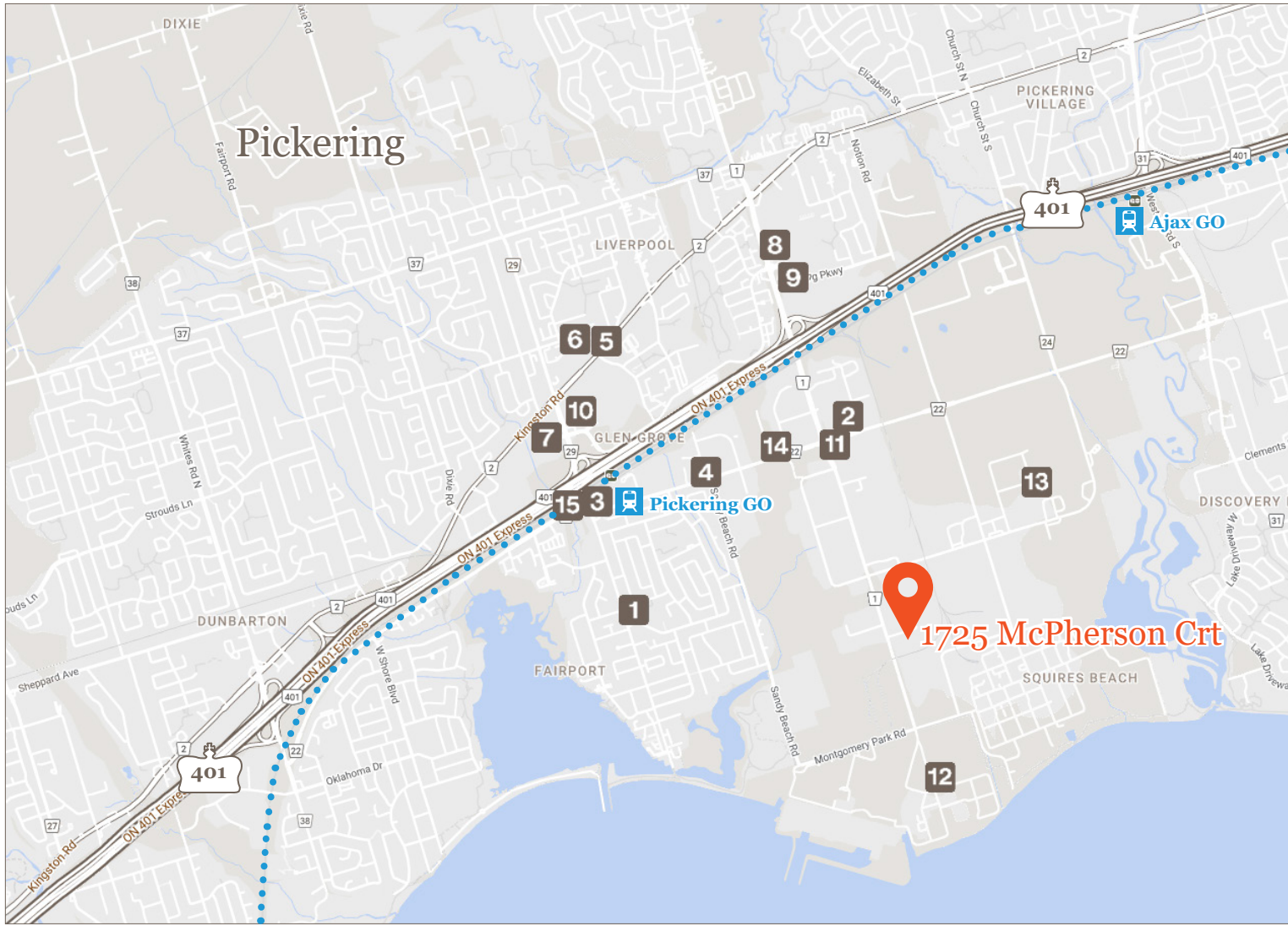

What's Near By

- 1 Petro-Canada
- 2 Husky
- 3 Shell
- 4 RBC
- 5 CIBC
- 6 BMO
- 7 Loblaws
- 8 Walmart
- 9 Canadian Tire
- 10 Pickering Town Centre
- 11 Subway
- 12 Tim Hortons
- 13 Casino Pizza
- 14 Harvey's
- 15 Starbucks

1725 McPherson Court



*A bright
future
for your
business
is right
here.*

Lennard:

lennard.com

Lennard:

Jonathan Gorenstein* MBA, SIOR
Partner
905.917.2044
jonathan@lennard.com

Paul Wells**
Associate Vice President
416.275.3514
pwells@lennard.com

209-1 Yorkdale Road, North York
905.752.2220

*Broker ** Sales Representative
Statements and information contained are based on the information furnished by principals and sources which we deem reliable but for which we can assume no responsibility. Lennard Commercial Realty, Brokerage.