



2036

YOUR BRAND HERE

For Lease: Industrial

2036 Ellesmere Road

Industrial Freestanding Building

Lennard:

Here is where your business will *grow*.

lennard.com

2036 Ellesmere Road

Industrial freestanding building located at the intersection of Ellesmere Road and Markham Road.



Size

17,773 SF



Clear Height

20'

Shipping

4 Truck Level Doors



Availability

Immediate



Net Rent

\$20.00 PSF

Additional Rent

\$5.40 PSF



Listing Agents

Marty Atkins**

Vice President

416.565.3455

matkins@lennard.com

**Broker

Property Highlights

- Newer Industrial freestanding building
- Finished A/C office area consists of showroom, kitchen area, large office & two 2 - piece washrooms, tile floor
- Located near major intersection, Hwy 401 & Hwy 407 and public transportation
- Ample parking
- Shipping area can handle 53 foot trailers
- Ideal for warehouse and or distribution

2036 Ellesmere Road



Lennard:

Marty Atkins**, Vice President
416.565.3455 • gcrosby@lennard.com

**Broker

lennard.com

2036 Ellesmere Road



*A bright future
for your business
is right here.*

Lennard:

Marty Atkins**, Vice President
416.565.3455 • gcrosby@lennard.com

**Broker

lennard.com

2036 Ellesmere Road

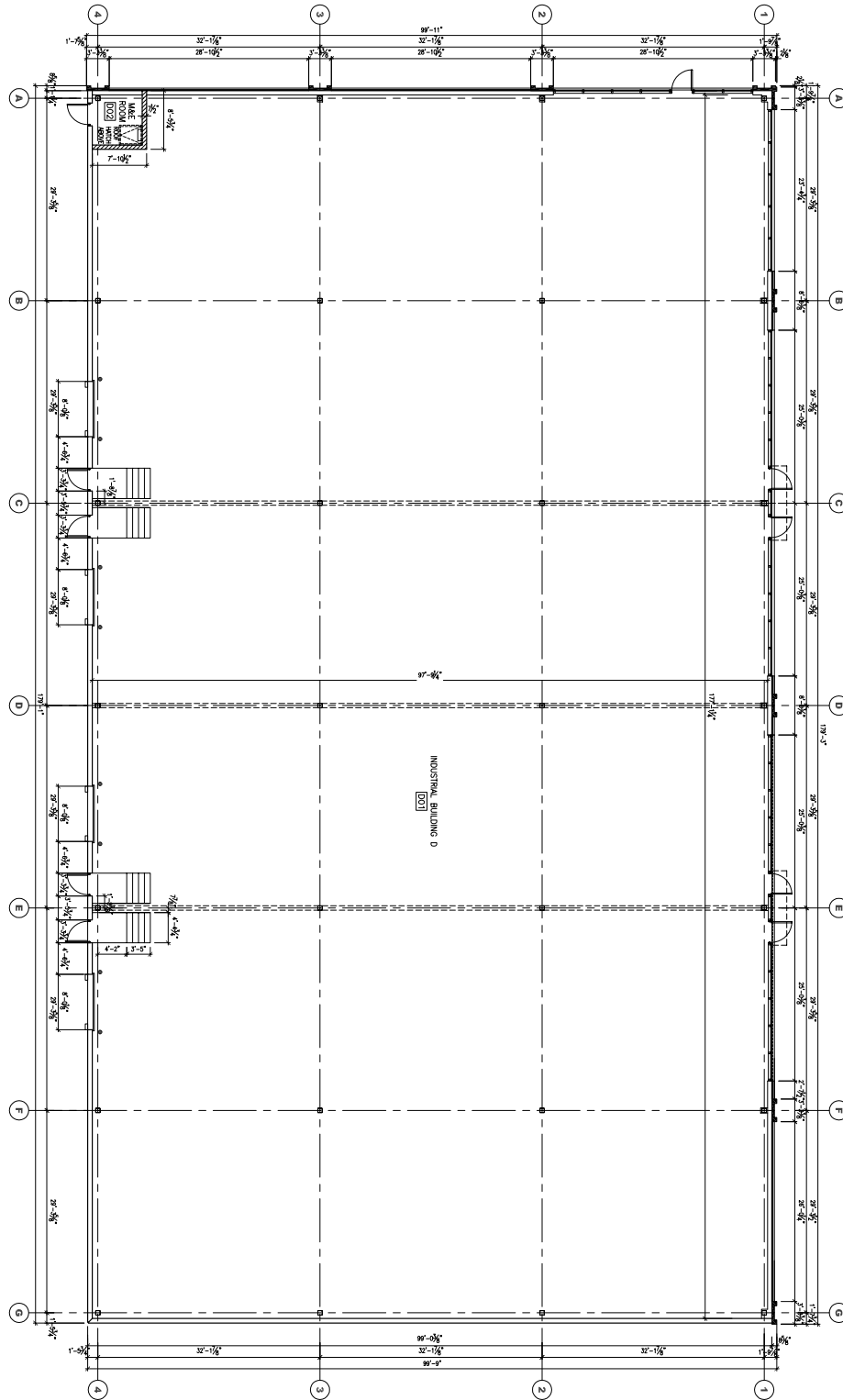

Lennard:

Marty Atkins**, Vice President
416.565.3455 • gcrosby@lennard.com

**Broker

lennard.com

Lennard:

Marty Atkins**, Vice President
416.565.3455
matkins@lennard.com

201-60 Columbia Way, Markham
905.752.2220
lennard.com

**Broker

Statements and information contained are based on the information furnished by principals and sources which we deem reliable but for which we can assume no responsibility. Lennard Commercial Realty, Brokerage.