



For Lease: Industrial

## 2 Select Avenue, Unit 16

Rare 3,170 SF Industrial Unit in Established Industrial Node

**Lennard:**

Here is where your business will *grow*.

[lennard.com](http://lennard.com)



# 2 Select Avenue, Unit 16



Unit 16  
**3,170 SF**

Office  
**20%**

Industrial  
**80%**



Shipping  
**1 Truck Level**



Clear Height  
**17'**



Power  
**600 Volts, 60 Amps**



Net Rent  
**\$18.25 PSF**

Additional Rent  
**\$4.34 PSF (2024)**



Listing Agent  
**Marty Atkins\*\***  
Vice President

416.565.3455  
matkins@lennard.com

\*\*Broker

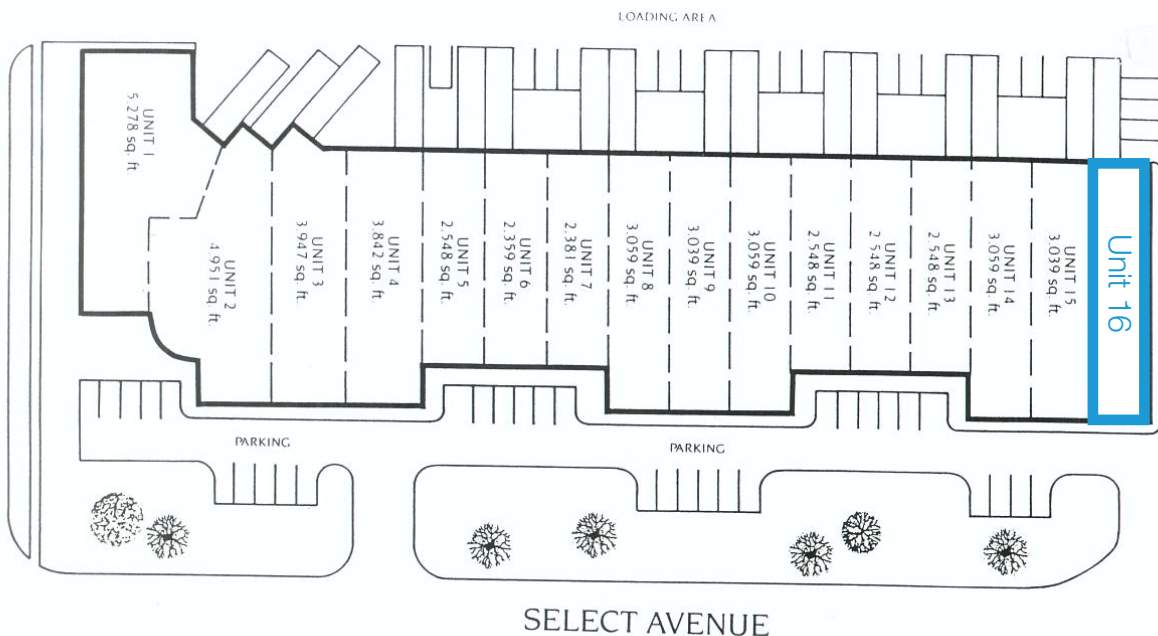

# 2 Select Avenue

## Floor Plan

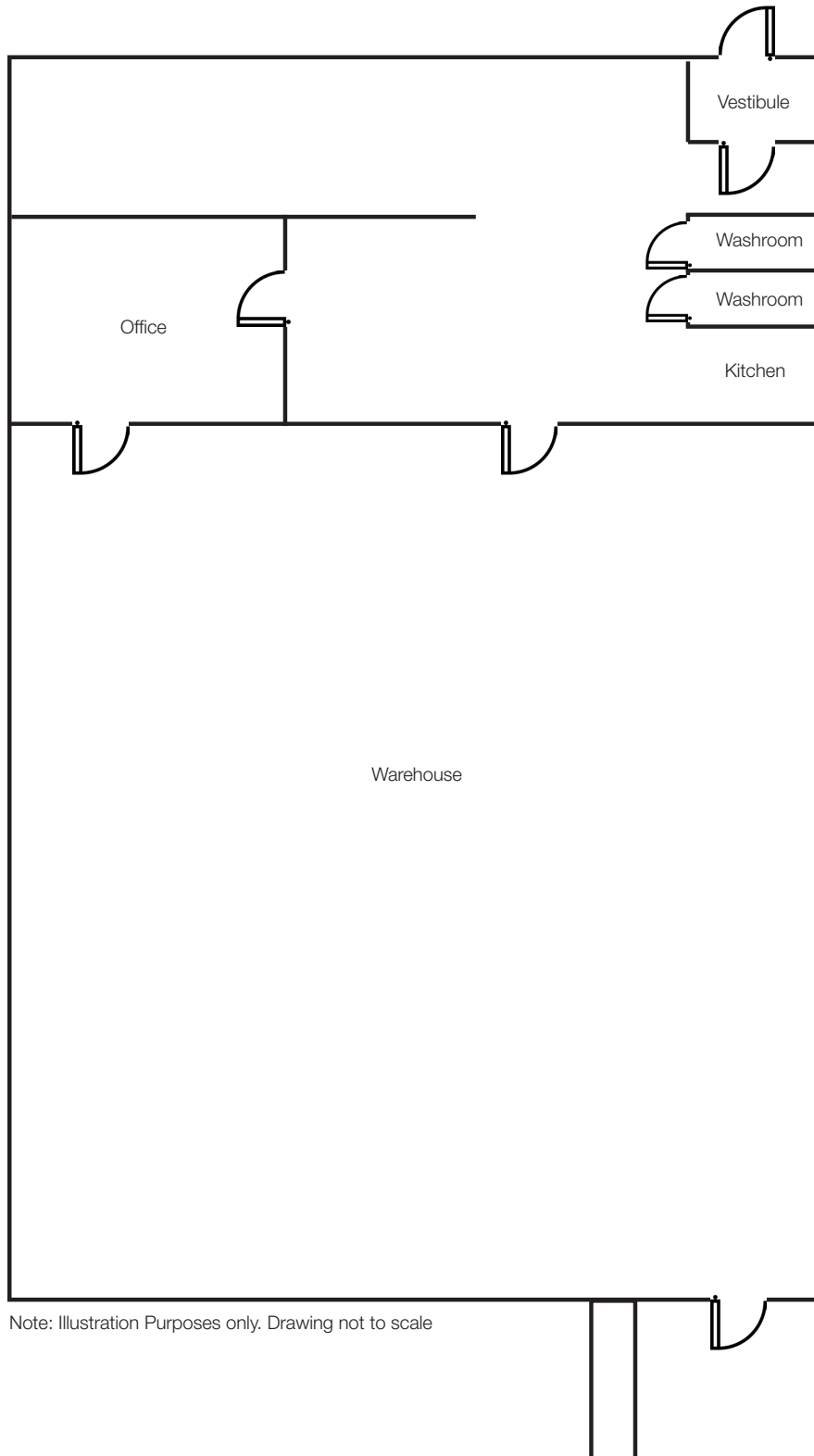

Note: Illustration Purposes only. Drawing not to scale

**Lennard:**

Marty Atkins\*\*, Vice President  
416.565.3455 • matkins@lennard.com

\*\*Broker

[lennard.com](http://lennard.com)

# 2 Select Avenue, Unit 16



Industrial unit for lease at the corner of Middlefield Road and Select Avenue, just south of Steeles Avenue E in Scarborough.

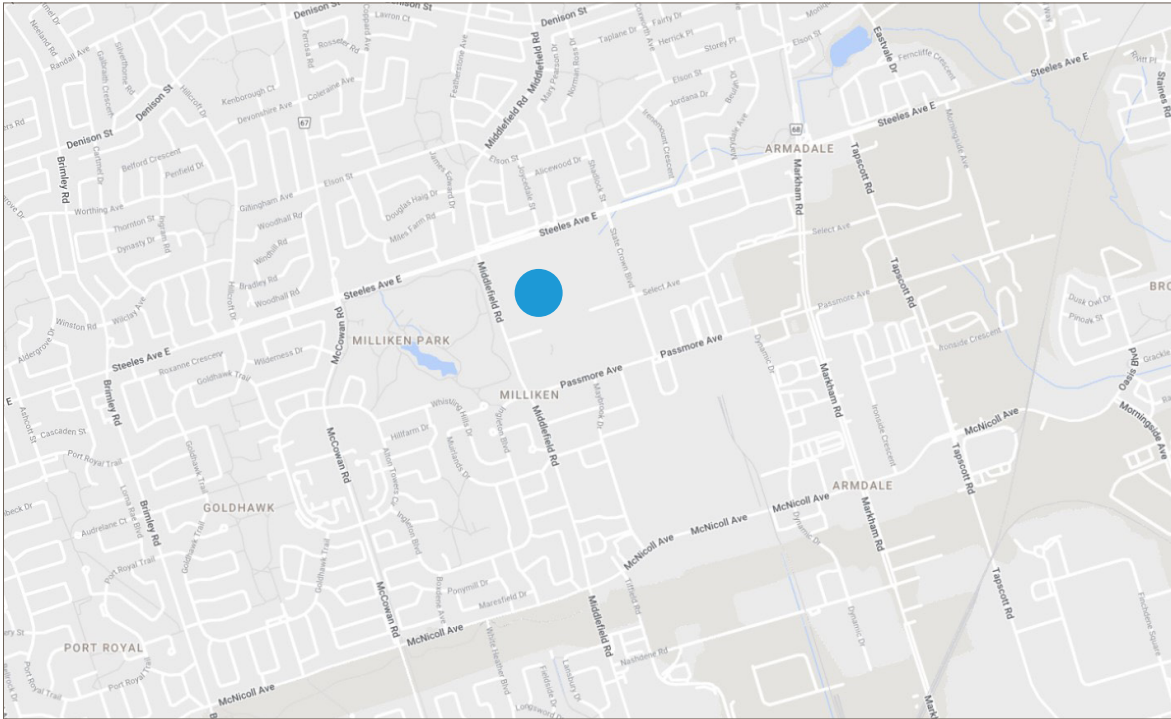

## Property Highlights

- Nicely finished industrial unit
- 1 office, reception area and work area
- Excellent location
- Close to Hwys 407 & 401
- Ideal for warehousing and distribution
- Good clean industrial unit



# 2 Select Avenue, Unit 16



**Lennard:**

Marty Atkins\*\*, Vice President  
416.565.3455 • [matkins@lennard.com](mailto:matkins@lennard.com)

\*\*Broker

[lennard.com](http://lennard.com)

# Lennard:

Marty Atkins\*\*, Vice President  
416.565.3455  
[matkins@lennard.com](mailto:matkins@lennard.com)

201-60 Columbia Way, Markham  
905.752.2220  
[lennard.com](http://lennard.com)

\*\*Broker

Statements and information contained are based on the information furnished by principals and sources which we deem reliable but for which we can assume no responsibility. Lennard Commercial Realty, Brokerage.